

REF

70200008



Check product function - Kontrollera produktens funktion

Visual inspection - Visuell inspektion

Check product function regularly. Ensure that the material is free from damage. If damage is apparent, the product must be discarded.

Kontrollera produktens funktion regelbundet. Kontroller att materialet är oskadat. Vid synlig skada ska produkten kasseras.



Always read the manual - Läs alltid manualen

Always read the manuals for all assistive devices used during the transfer.

Keep the manual where it is easily accessible for users of the product.

Never leave a user unattended during a transfer.

Läs alltid bruksanvisningarna för alla hjälpmedel som används vid en förflyttning.

Förvara bruksanvisningen tillgänglig för användare av produkten.

Lämna aldrig en brukare under en förflyttning.

Table of contents

English	3
Svenska	9

Purpose

The purpose of this instruction is to show how to properly hook and unhook a slingbar with an attached Swifthook to and from its correct place on a Handicare lift. It is also to show how slingbar and lift that comes with an installed Swifthook may be used without it.

Hooking the Swifthook to a lift arm

1. Hold the sling bar with the Swifthook at an angle relative the lift arm according to the image.
2. Push the sling bar to the side so that it “hooks on” completely
3. Lower the sling bar so that it hangs freely and horizontally as described in section “Correct position” below.

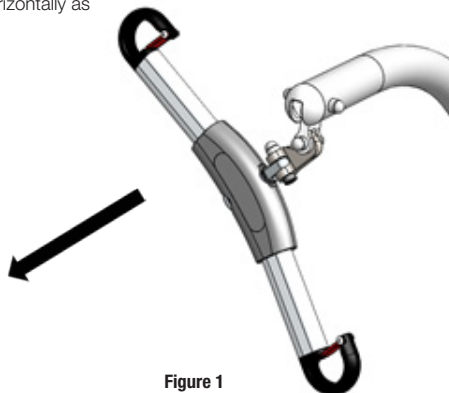

Unhooking the Swifthook from a lift arm

1. Hold the sling bar with the Swifthook at an angle relative the lift arm according to the image.
2. Push the sling bar to the side so that it unhooks completely.

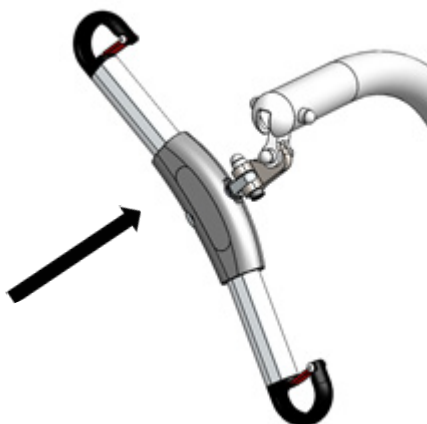

Correct position

The following figure 3,4 illustrates the correct position of a sling bar with Swifthook on a lift arm. The sling bar hangs freely and horizontally and the Swifthook is completely hooked on. During a lift, ensure that the user is not touching or pushing on the slingbar in any way.

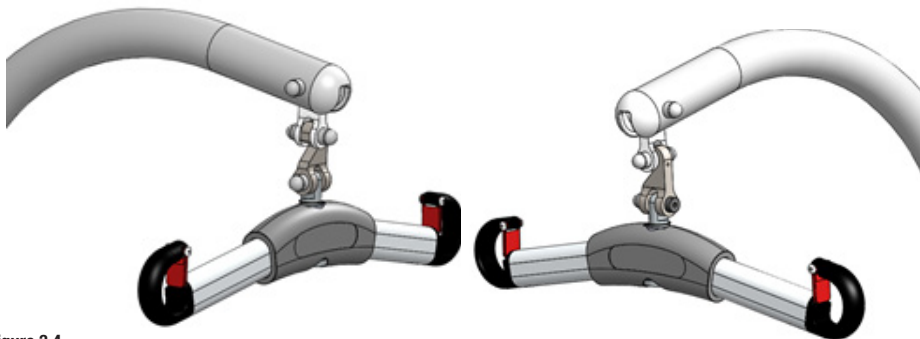

Figure 3,4

Incorrect and faulty position

The following illustrations shows incorrect position. Note the mark in, figure 5. In case the Swifthook ends up in this position, do not start the lift. If there is an ongoing lift discontinue by slowly lowering the lift arm with the hand control until the sling bar is unloaded. Then correct the sling bars position.

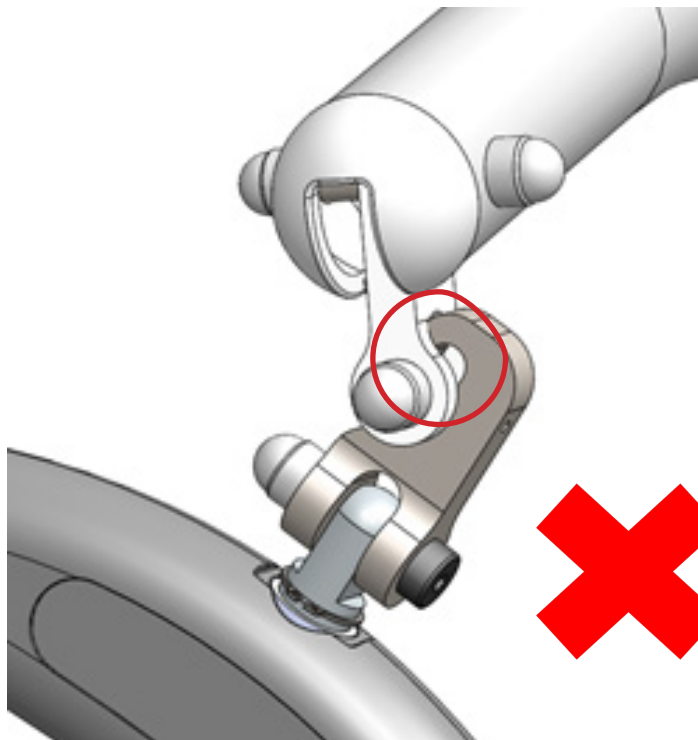

Figure 5

Incorrect and faulty position

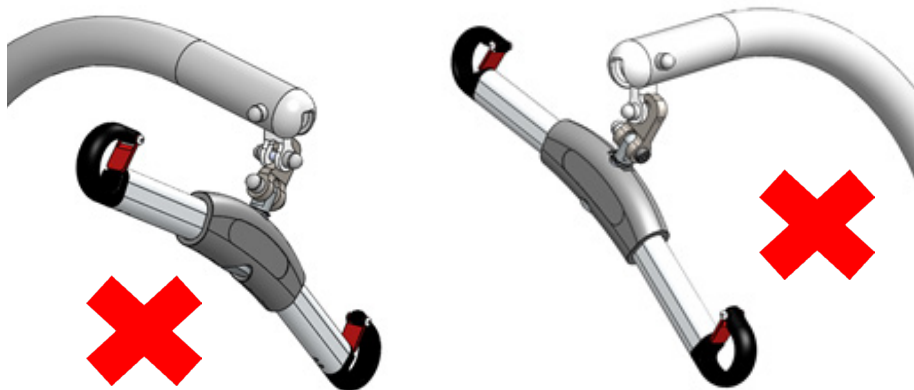

Figure 6,7

Correct position on a ceiling lift H-adapter

The following images (8,9) shows the correct position of a slingbar with Swifthook on a ceiling lift strap with the H-adapter.

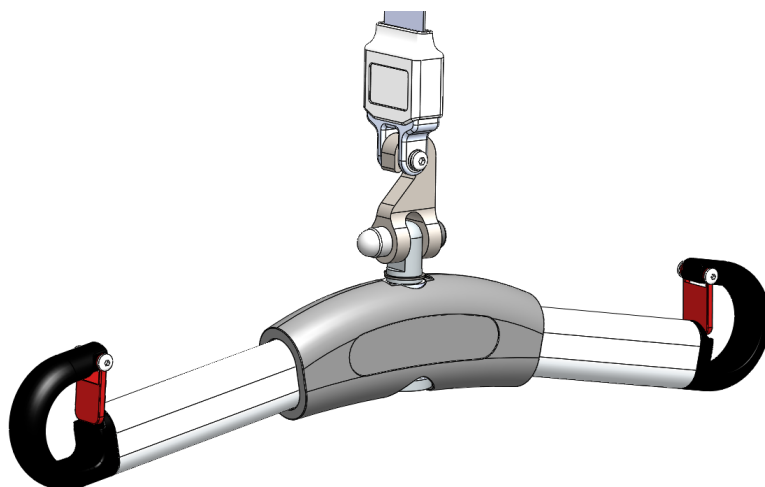

Figure 8

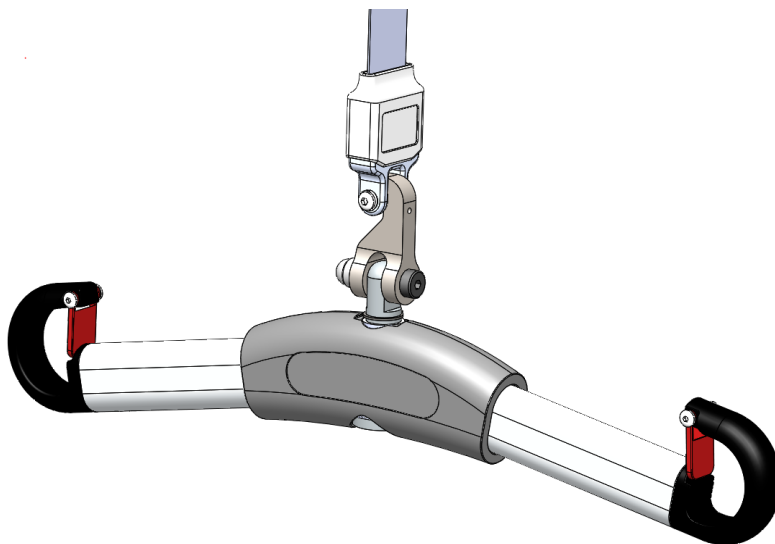

Figure 9

Removing the Swifthook from the slingbar

Remove the Swifthook using the appropriate Allen key (5mm) and wrench (13mm). See figure 10.

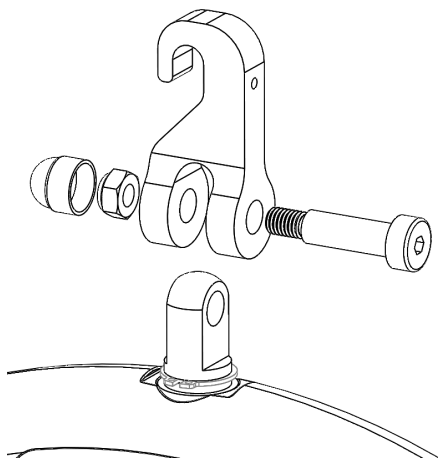

Figure 10

Attaching the Slingbar directly to the lift arm of the lift

Use two wrenches (13mm). Remove the Swifthook from the slingbar as in the previous section. Remove the fastener from the lift's link arm as in Figure 11. Attach the sling bar directly to the lift arm as in Figure 12. Check that the lock nuts are undamaged and still offers resistance to tightening by hand, and if not, replace with new nuts. (DIN985 M8fzb lock nut)

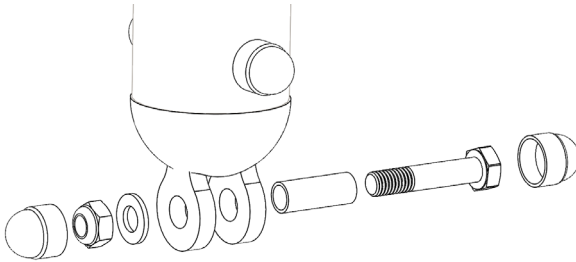

Figure 11

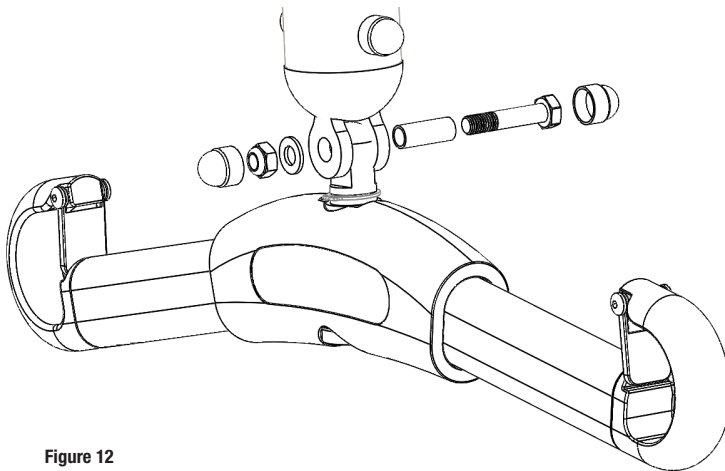

Figure 12

Syfte

Syftet med denna instruktion är att visa korrekt sätt att kroka på och av en lyftbygel med en Swifthook till och från sin korrekta plats på en lyft från Handicare. Den visar också hur en lyftbygel och lyft som kommer med en monterad Swifthook kan användas utan Swifthook.

Kroka på en Swifthook på lyftarm

1. Håll lyftbygeln med Swifthook i en vinkel mot lyftarmen enligt bild.
2. För lyftbygeln åt sidan så att den krokas på helt.
3. Sänk sedan lyftbygeln sakta tills den hänger fritt i horisontell position enligt "Korrekt position" nedan

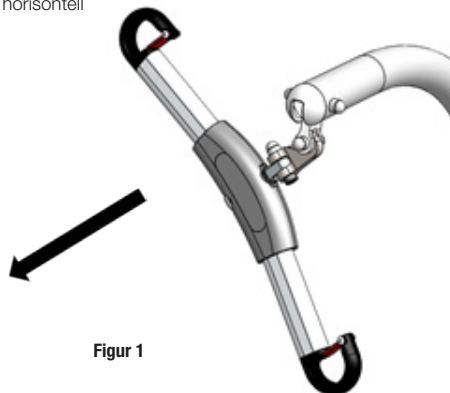

Kroka av en Swifthook från en lyftarm

1. Håll lyftbygeln i en vinkel mot lyftarmen enligt bild.
2. För lyftbygeln åt sidan så att den krokas av helt.

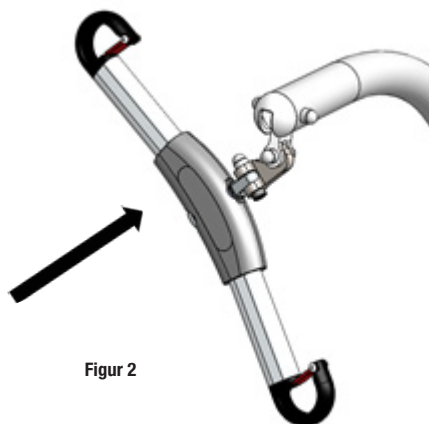

Korrekt position

Följande illustrationer visar korrekt position av Swifthook på lyftarmen. Lyftbygeln hänger fritt och horisontellt och Swift-hook är fullständigt påkrokad. Under ett lyft, se till att brukaren inte rör vid eller pressar på lyftbygelns på något sätt.

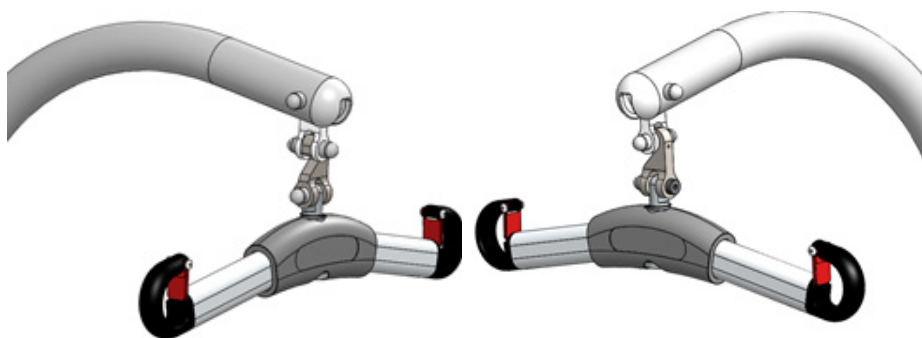

Felaktig position

Följande illustrationer visar felaktig position. Notera markeringen i figur 5. I de fall då Swifthook hamnar i denna position, påbörja ej lyftet. Om ett lyft pågår, avbryt genom att långsamt sänka lyftarmen mha handkontrollen tills lyftbygelns är obelastad. Rätta sedan till lyftbygelns position.

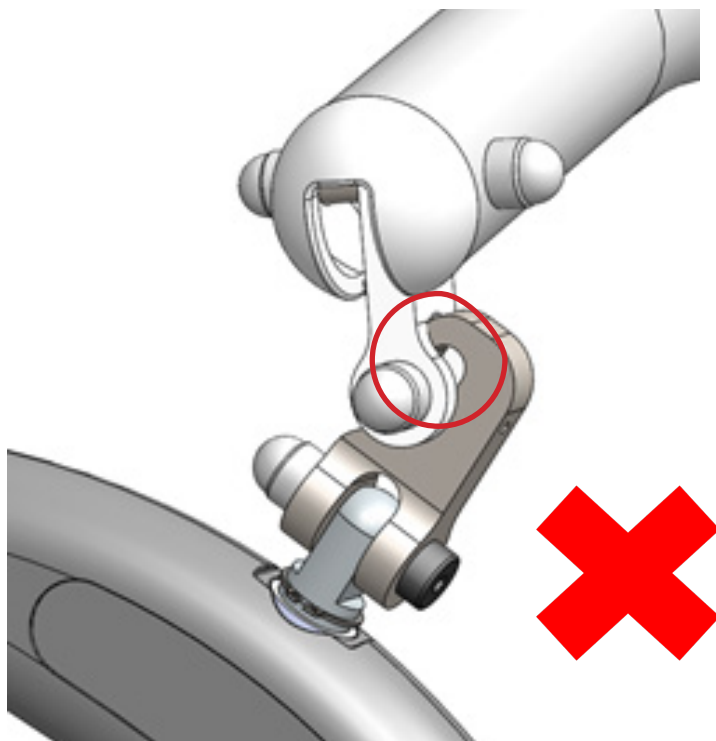

Figur 5

Felaktig position

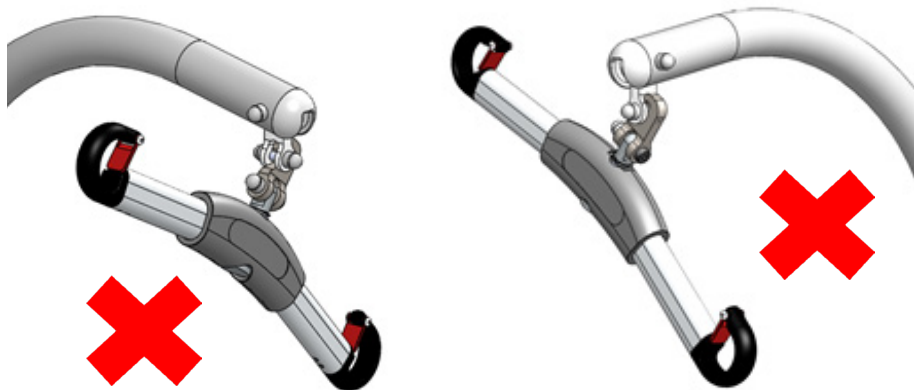

Figur 6,7

Korrekt position på en taklyft H-adapter

Följande illustrationer (8,9) visar den korrekta positionen hos en lyftbygel med Swifithook på en taklyfts H-adapter.

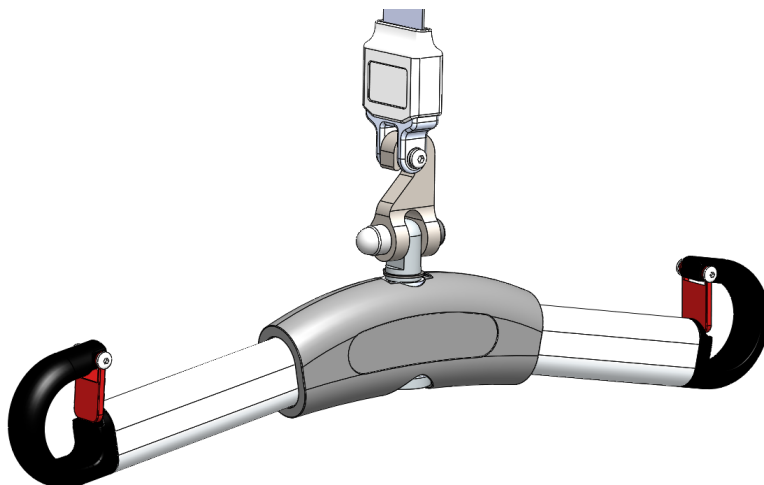

Figure 8

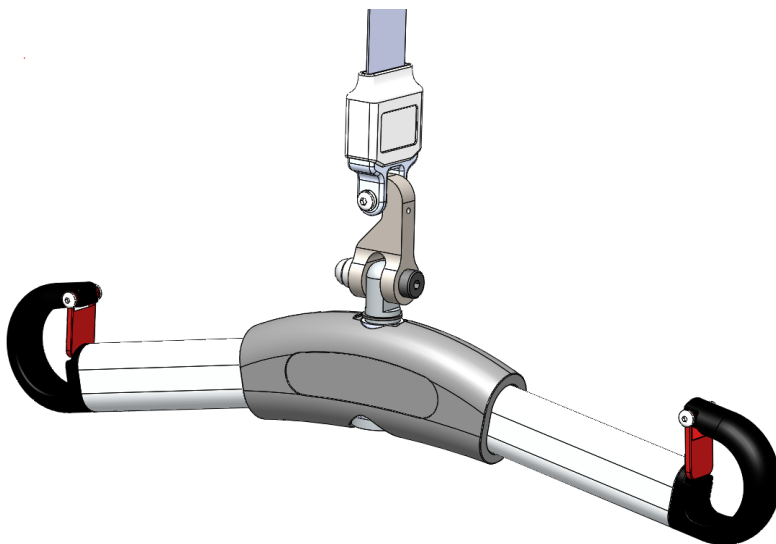
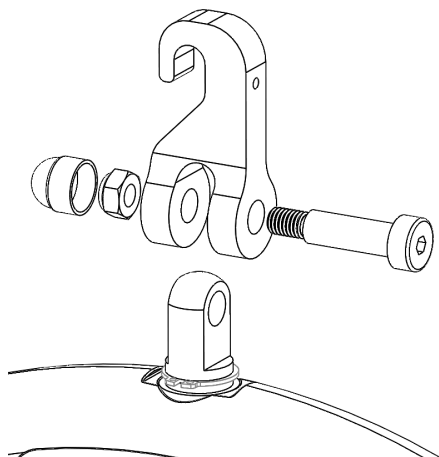

Figure 9

Avmontering av Swifthook från lyftbygel

Montera av Swifthook mha en insexnyckel (5mm) och blocknyckel (13mm). Se figur 10.



Figur 10

Montering av lyftbygel direkt på lyftarm utan Swifthook

Använd två blocknycklar (13mm). Montera av Swifthook enligt ovan. Montera av bult, mutter och bricka enligt figur 11. Montera lyftbygeln direkt på lyftarmen enligt figur 12. Kontrollera att låsmutterarna inte är skadade och att de ger mostånd mot åtdragning för hand, och om inte, byt ut mot nya låsmutterar. (DIN985 M8fzb låsmutter)

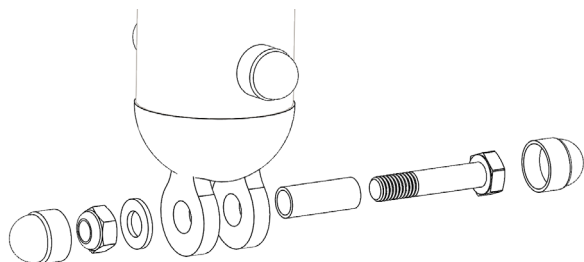

Figur 11

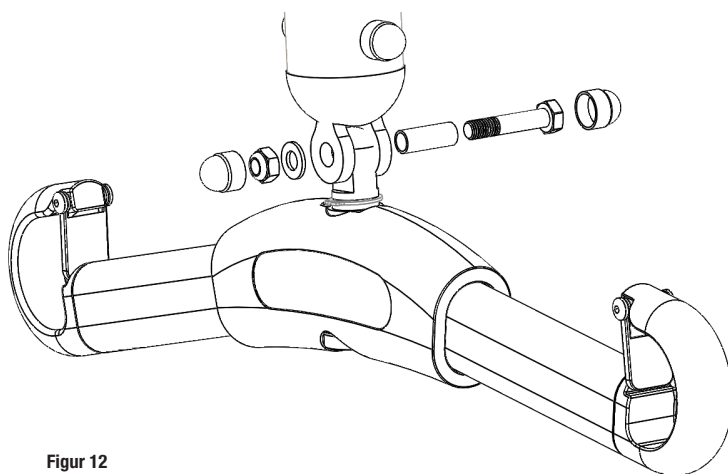

Figur 12

Simple solutions for great results

Handicare offers a unique easy transfer concept, the market's widest and most comprehensive range of clever, easy-to-use and safe transfer and lifting aids designed to make life easier, both for the user and for the caregiver. We have a complete solution that provides for the majority of patient transfer or manual handling requirements. From the simplest to the most complex scenarios, from the lightest to the heaviest. The concept encompasses assistive devices for four different categories of transfers:

- Transfer, assistive devices for manual transfers of users between two locations.
- Positioning, assistive devices for manual repositioning of users within the same location.
- Support, assistive devices for mobility support e.g., during sit-to-stand or gait training.
- Lifting, assistive devices for manual and mechanical lifting of users.

Improved work environment, improved quality of care and cost savings

The Handicare patient transfer product range is focused on the prevention and reduction of occupational injuries while allowing users to experience a greater sense of independence and dignity. Through a unique combination of training and a complete range of efficient transfer aids, Handicare offers improvement of both work environment and quality of care and, at the same time, achieves significant cost savings.

Always make sure that you have the correct version of the manual

The most recent version of all manuals are available for downloading from our website; www.handicare.com.

For questions about the product and its use

Please contact your local Handicare representative. A complete list of all our partners with their contact details can be found on our website; www.handicare.com.

Handicare offers solutions and support to increase the independence of disabled or elderly people as well as to improve the convenience of those who are caring for them.

The Handicare Group is one of the leading healthcare companies in Europe with its own manufacturing organizations and sales companies in Norway, Sweden, Denmark, Germany, the Netherlands, Great Britain, France, China, Canada and the USA. Handicare's products are also distributed by partners in more than 40 countries worldwide. Our wide range of high-quality products includes a complete easy transfer system and other patient handling aids, stairlifts, car adaptations and bathing and toileting products.